

# Akış kontrol Valfi / Flow Control Valve

Valfler / Valves

# MAG®



## FKV 1/8" - 1/4" - 1/2"

Akış Miktarı Flow Rate	FKV 1/8	FKV 1/4	FKV 1/2
Kısma Yönünde Through adjusting direction	0 ... 125 lt/min	0 ... 450 lt/min	0 ... 800 lt/min
Serbest Yönünde Through free flow direction	125 lt/min	450 lt/min	800 lt/min
Bağlantı Ölçüsü Connection	R 1 / 8"	R 1 / 4"	R 1 / 2"
Ağırlık / Weight	0,035 kg	0,130 kg	0,245 kg
Çalışma Basıncı Operating pressure range		0,5 ... 10 bar	
Çalışma Sıcaklığı Ambient temp. range		-20 ... +80 °C	
Akışkan Türü / Fluid type	Filtre edilmiş kuru veya yağlı hava / Lubricated or unlubricated filtered air		

## AKIŞ ÖZELLİKLERİ / FLOW CHARACTERISTICS

FKV 1/8

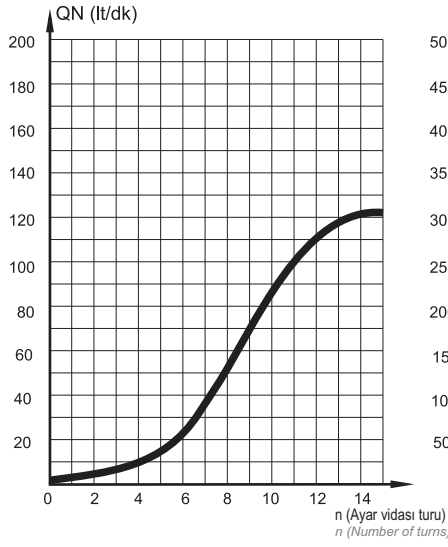

FKV 1/4

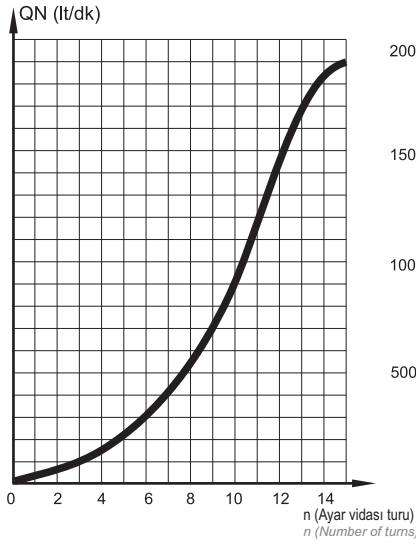

FKV 1/2

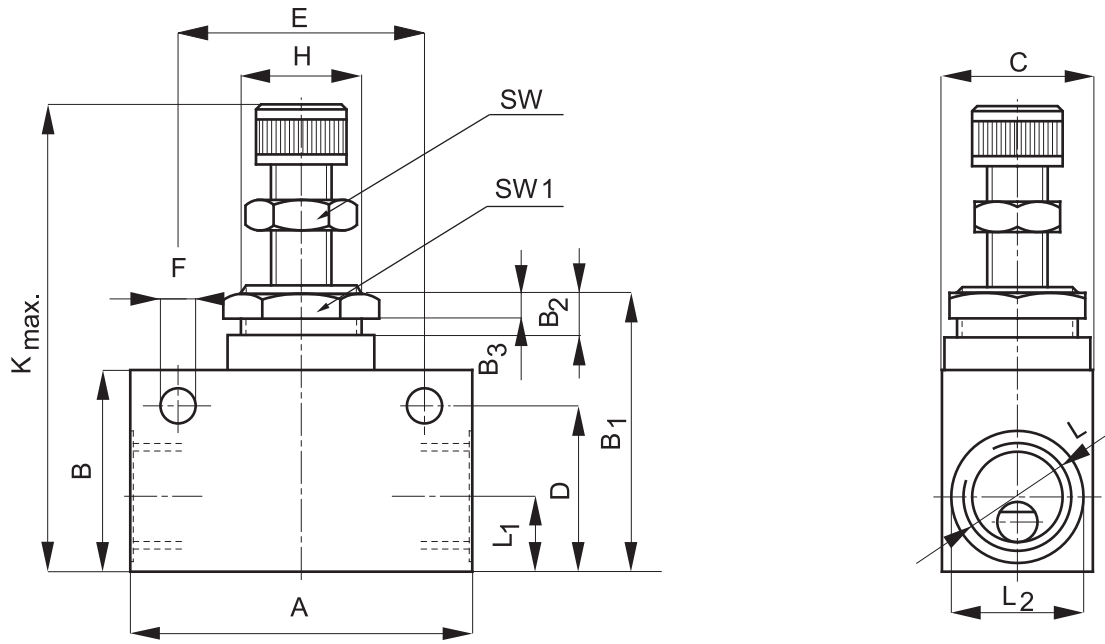
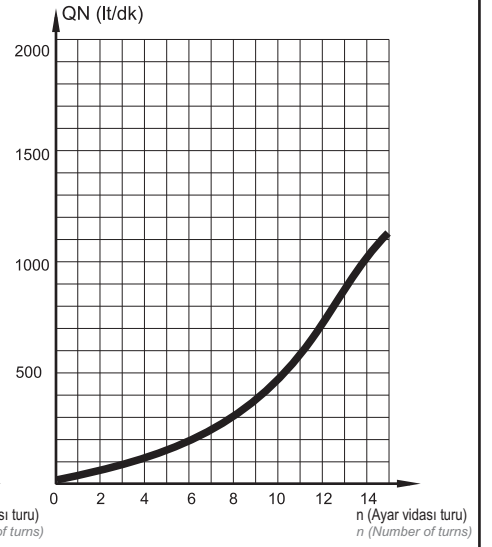

TİP / Type	A	B	B <sub>1</sub>	B <sub>2</sub>	B <sub>3</sub>	C	D	E	øF	H	L <sub>1</sub>	L <sub>2</sub>	øL	K <sub>MAX.</sub>	SW	SW <sub>1</sub>
FKV 1/8	32.5	22	31.5	6	2.5	16	17.5	24	4.4	M12x1	G1/8	9	13.5	52	10	17
FKV 1/4	55	32	48	10	4.5	25	25	35	6.5	M20x1.5	G1/4	12	-	72	13	22
FKV 1/2	68	40	57	10	5.0	30	33	50	6.5	M24x1.5	G1/2	15	-	92	19	27